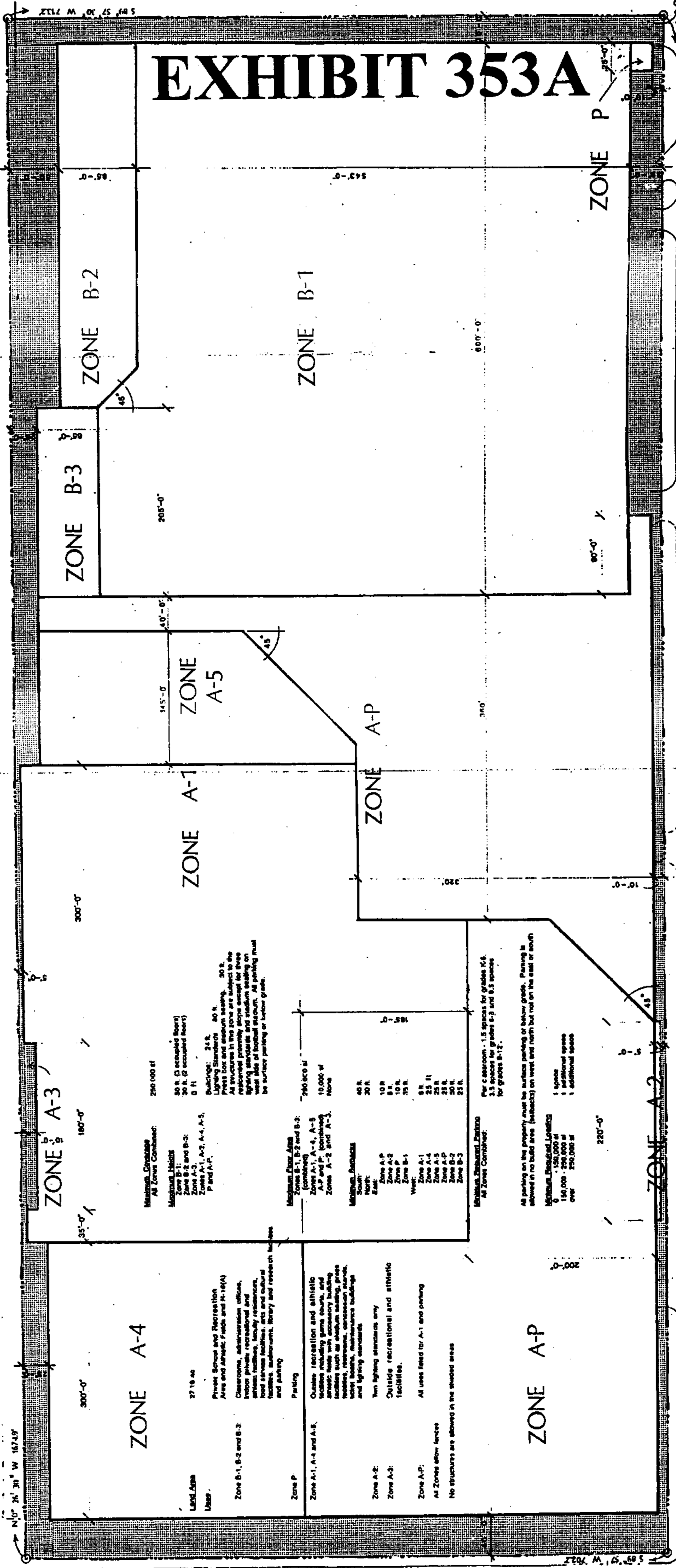
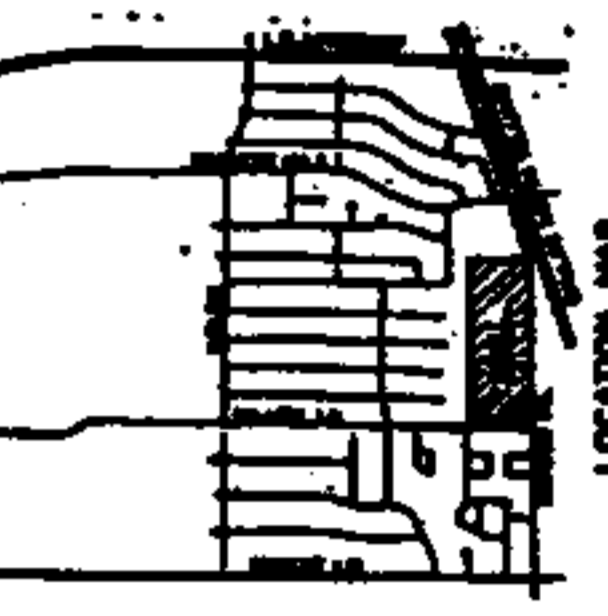

EXHIBIT 353A



SINGLE FAMILY DETACHED HOMES



JESUIT COLLEGE PREPARATORY SCHOOL

PLANNED DEVELOPMENT DISTRICT CONCEPTUAL PLAN

APPROXIMATE ACCESS POINT

NO BUILD ZONE

934-1360
 1-27-24
 9954-1361-5791-7

940855
 21976
 APPROVED BY
 CITY COUNCIL